

Hollow Pin Chain

**QUICK
REFERENCE
GUIDE**

- ▶ Solid Hollow Pin Bushing ▶ Perfectly Cylindrical Inside Bushing Diameter
- ▶ Operates On Standard Sprockets

HKK Hollow Pin chains are constructed with cold-forged solid bushings. This process assures the inside diameter of the bushing is completely cylindrical all the way through. This unique hollow pin feature allows easy insertion of cross rods without damaging the chain or rods. Hollow Pin chain operates on standard sprockets and standard double pitch sprockets.

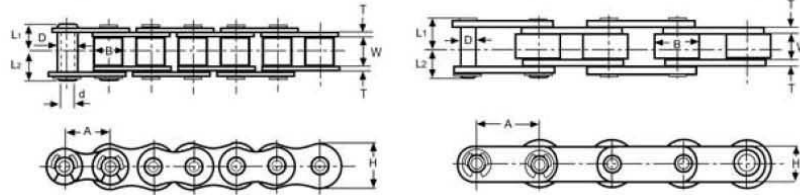

HKK Hollow Pin Chain No.	Pitch	Roller		Pin		Plate		Overall Width		Maximum Allowable Load (lbs)	Average Ultimate Strength (lbs)	Avg. Weight Per Foot (lbs)
		Dia.	Width	Outside Dia.	Inside Dia.	Height	Thickness	L1	L2			
	A	B	W	D	d	H	T					
HKK 40-HP	1/2	0.312	0.312	0.222	0.158	0.472	0.060	0.327	0.362	400	3,000	0.39
HKK 50-HP	5/8	0.400	0.375	0.280	0.202	0.591	0.080	0.404	0.453	700	4,400	0.65
HKK 60-HP	3/4	0.469	0.500	0.327	0.238	0.718	0.094	0.508	0.555	950	7,500	0.98
HKK 80-HP	1	0.625	0.625	0.446	0.318	0.949	0.125	0.638	0.758	1,700	11,400	1.66
Conveyor Type												
HKK C2040-HP	1	0.312	0.312	0.222	0.158	0.472	0.060	0.327	0.362	400	3,000	0.31
HKK C2050-HP	1-1/4	0.400	0.375	0.280	0.202	0.591	0.080	0.404	0.453	700	4,400	0.51
HKK C2060-HP	1-1/2	0.469	0.500	0.327	0.238	0.670	0.094	0.508	0.555	950	7,500	0.75
HKK C2080-HP	2	0.625	0.625	0.446	0.318	0.890	0.125	0.638	0.758	1,700	11,400	1.33
Carrier Roller Type												
HKK C2042-HP	1	0.625	0.312	0.222	0.158	0.472	0.060	0.327	0.362	400	3,000	0.54
HKK C2052-HP	1-1/4	0.750	0.375	0.280	0.202	0.591	0.080	0.404	0.453	700	4,400	0.84
HKK C2062-HP	1-1/2	0.875	0.500	0.327	0.238	0.670	0.094	0.508	0.555	950	7,500	1.20
HKK C2082-HP	2	1.125	0.625	0.446	0.318	0.890	0.125	0.638	0.758	1,700	11,400	2.13

Dimensions in inches & pounds